



Lichfield Road | Armitage, Rugeley | WS15 4DE

Offers In The Region Of £240,000



Summary

**** IDEAL FIRST TIME BUYER PURCHASE ** SPACIOUS FAMILY HOME ** POPULAR LOCATION ** THREE BEDROOMS ** FAMILY BATHROOM ** LOUNGE ** GENEROUS KITCHEN DINER ** FRONT& REAR GARDENS ** DRIVEWAY ** VIEWING ADVISED ****

WEBBS ESTATE AGENTS are pleased to bring to the market this well-presented three-bedroom semi-detached home, situated in the highly sought-after village of Armitage. This delightful property offers generous living space and is ideally suited to first-time buyers looking to step onto the property ladder. Viewing is highly recommended to fully appreciate the size and space on offer. The property enjoys a prime position on Lichfield Road, conveniently close to local amenities, reputable schools and excellent transport links. Armitage is a well-regarded village offering a friendly community atmosphere while benefiting from easy access to Rugeley, Lichfield and surrounding areas. Briefly Comprising: Entrance Porch, Through Hallway, Lounge, Kitchen Diner, Three Bedrooms, Family Bathroom, Rear Garden, Driveway Garage. In summary, this property is a fantastic opportunity for first-time buyers or young families looking for a home in a desirable village location. Contact us today to arrange a viewing and see all that this home has to offer!

Key Features

- POPULAR VILLAGE LOCATION
- LOUNGE
- DRIVEWAY
- GARAGE
- IDEAL FOR FIRST TIME BUYERS
- THREE BEDROOMS
- KITCHEN DINER
- GOOD SIZE REAR GARDEN
- CLOSE TO AMENITIES
- VIEWING ESSENTIAL

Rooms and Dimensions

ENTRANCE PORCH

THROUGH HALLWAY

LOUNGE

11'11" x 11'5" (3.64m x 3.48m)

GENROUS KITCHEN DINER

18'6" x 9'3" (5.64m x 2.82m)

LANDING

BEDROOM ONE

11'3" x 11'4" (3.44m x 3.46m)

BEDROOM TWO

10'0" x 9'10" (3.05m x 3.02m)

BEDROOM THREE

10'10" x 6'5" (3.31m x 1.98m)

FAMILY BATHROOM

LANDSCAPED GARDENS

DRIVEWAY

Identification Checks (R)





Approx Gross Internal Area
79 sq m / 854 sq ft

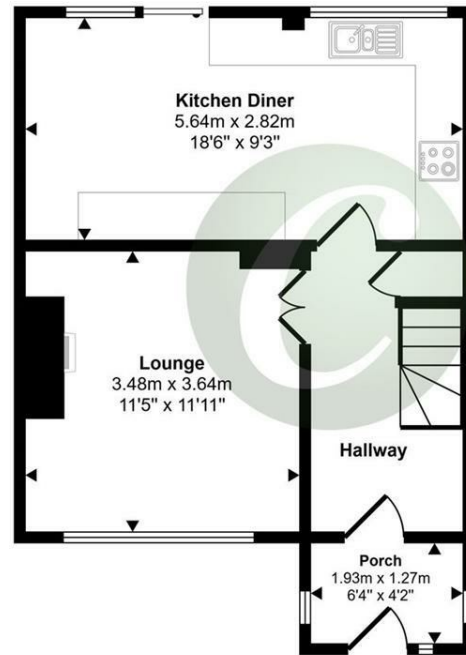

Ground Floor
Approx 40 sq m / 426 sq ft

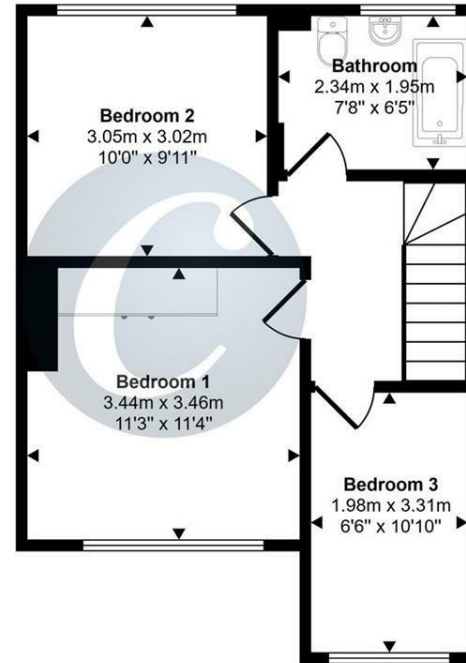

First Floor
Approx 40 sq m / 428 sq ft

This floorplan is only for illustrative purposes and is not to scale. Measurements of rooms, doors, windows, and any items are approximate and no responsibility is taken for any error, omission or mis-statement. Icons of items such as bathroom suites are representations only and may not look like the real items. Made with Made Snappy 360.

Webbs Estate Agents - endeavour to maintain accurate depictions of properties in Virtual Tours, Floor Plans and descriptions, however, these are intended only as a guide and purchasers must satisfy themselves by personal inspection.

